

RV25 系列 开关电位器
RV25 Series Switch Potentiometer

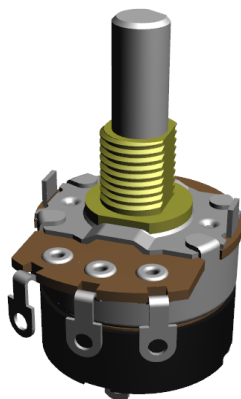

MAIN SPECIFICATION	
Total resistance	10K Ω
Resistance tolerance	$\pm 20\%$
Resistance pattern	A,B,C,D
Max operation voltage	Linear B: AC 500V; Other: AC 250V
Power Rate	Linear B: 0.5W; Other: 0.25W
Noise	Less than 100mV
Withstanding voltage	1 minute at AC 500V
Insulation resistance	More than 100M Ω at DC 500V
Residual Resistance Value	Term.1~2: Less than 10 Ω
	Term.2~3: Less than 10 Ω
Switch return route	S.P.S.T.
Switch contact resistance	Less than 50m Ω
Switch power rate	1.0A at AC/DC 125V
MECHANICAL	
Total Rotation Angle	300 ± 10 (degree)
Rotation Torque	30~200 gf.cm
Shaft Stop Strength	10.0Kgf.cm Min
push-pull strength	10.0 kgf Min
Switch rotation angle	50 ± 10 (degree)
Switch torque	150~800gf.cm
Durable performance	
Rotational Life	200,000 Cycles

RV25

